

DW CONEXION 99



Unit of measurement	Pieces/Pallet	Consumption	Color/Other specifications
25 kg/sack	54 pcs/pallet	3 - 5 kg/m ²	Grey White



DW CONEXION 99

Prepared, grey and white cement-based mortar, composed from Protland Cement with excellent qualities, carbonate stone filler with selected granulometry, synthetic resins and special additives, which improve the workability, adhesion, flexibility and increase the hydrophobicity of the dry mortar.

AREA OF USE

DW CONEXION 99 serves for the adhesion and then for the leveling of all types of panels that are usually used for the realization of thermal insulation systems, such as: styrofoam, polyurethane, wool stone, wool glass, graphite, mineral fibers in brick walls, concrete or cement-based mortar. DW CONEXION 99 is a pre-prepared, gray or white, cement-based, Portland material of excellent quality, with carbonate stone sand of selected granulometry, synthetic resins and special additives, which improve the workability, adhesiveness on rough surfaces and increase the hydrophobicity of the strengthened mortar against rains. The leveling of the panels should be made in two layers, combining those with glass- fibers mesh, which is resistant to alkali.

APPLICATION PROCEDURE

Surface preparation

The supports must be compact, seasoned and steady, without cracks, oils, paints or detachable parts. Check to see if the bricks are securely attached and do not have parts that can detach. If there are such parts, remove them and repair surface with mortar. Walls that are coated with grout must be scraped in order to verify if the surface under it was painted with old and badly attached paints, or if there are detachable parts. Powdered surfaces should be treated with PRIMER TECNO-FIX. Superficial cracks can be caulked with DW Conexion 99, while deep structural cracks should be treated in a way to eliminate the causes and make them not to repeat.

APPLICATION

In order to achieve a steady installation, before you start to adhere panels, it is necessary to fix metallic profiles as leveling fasteners. For installations in irregular surfaces, such as unplastered brick walls, the adhe-

sive is applied with a trowel, by putting it as a tape at the edges of the panels' sideways contours, and some drops in its center (or forming an X in the center of the panel) in a certain thickness so as to compensate unevenness. For applications in flat surfaces, it is recommended to spread the adhesive in the entire surface of the panel through a notched trowel (from 8 up to 10 mm). Caution must be paid to the surface covered with adhesive, which should be at least 40 % of the total panel surface. Panels should be installed in horizontal direction, starting from down and continuing up. Caution to the panels' joints; do not leave empty spaces or unevenness. Then, proceed with the mechanic fixation of wall anchors (for usual panels 50 x 100 cm, it is recommended to pour 8 adhesive drops for meter square).

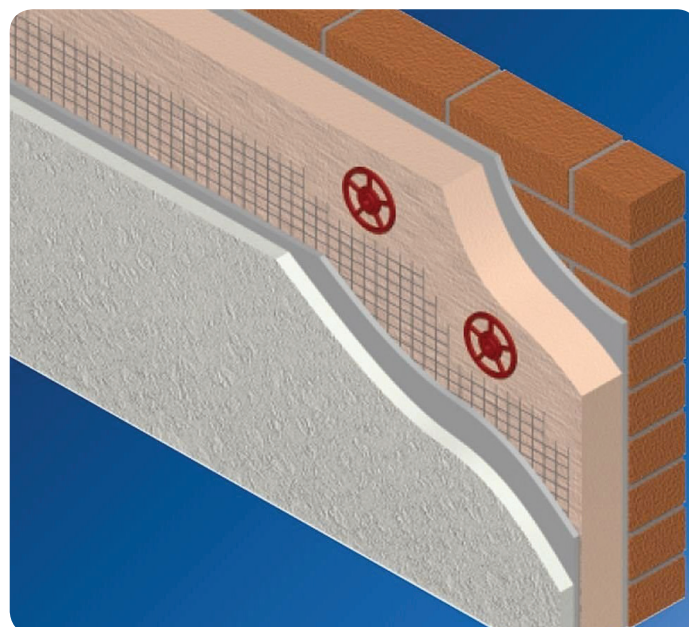



TECHNICAL DATA

Form	Powder
Color	Grey/White
Granulometriy	≤ 0.7 mm

TECHNICAL FEATURES

Water for mixing	26% (± 1%)
pH of mixture	>12
Pot life	4 hours
Application temperature	5°C to 35°C
Consumption for mm thickness	1.4 kg/m ²

FINAL DATA

Resistance to moisture	Very good
Deformation	Non deformable
Adhesion strength to concrete	≥ 2 N/mm ²
Adhesion strength after heat	≥ 1,0 N/mm ²
Adhesion strength after water immersion	≥ 1,0 N/mm ²
Compression resistance	≥ 12 N/mm ²
Flexibility	≥ 7 N/mm ²
Flexural resistance	≤ 2.5 mm

The above data are applicable in temperatures from (23 ±2°C) and in (50 ±5) % relative humidity. Lower temperatures prolong the time of maturity and solidifying.

